

THIS EDGE TOWARDS ROOF RIDGE

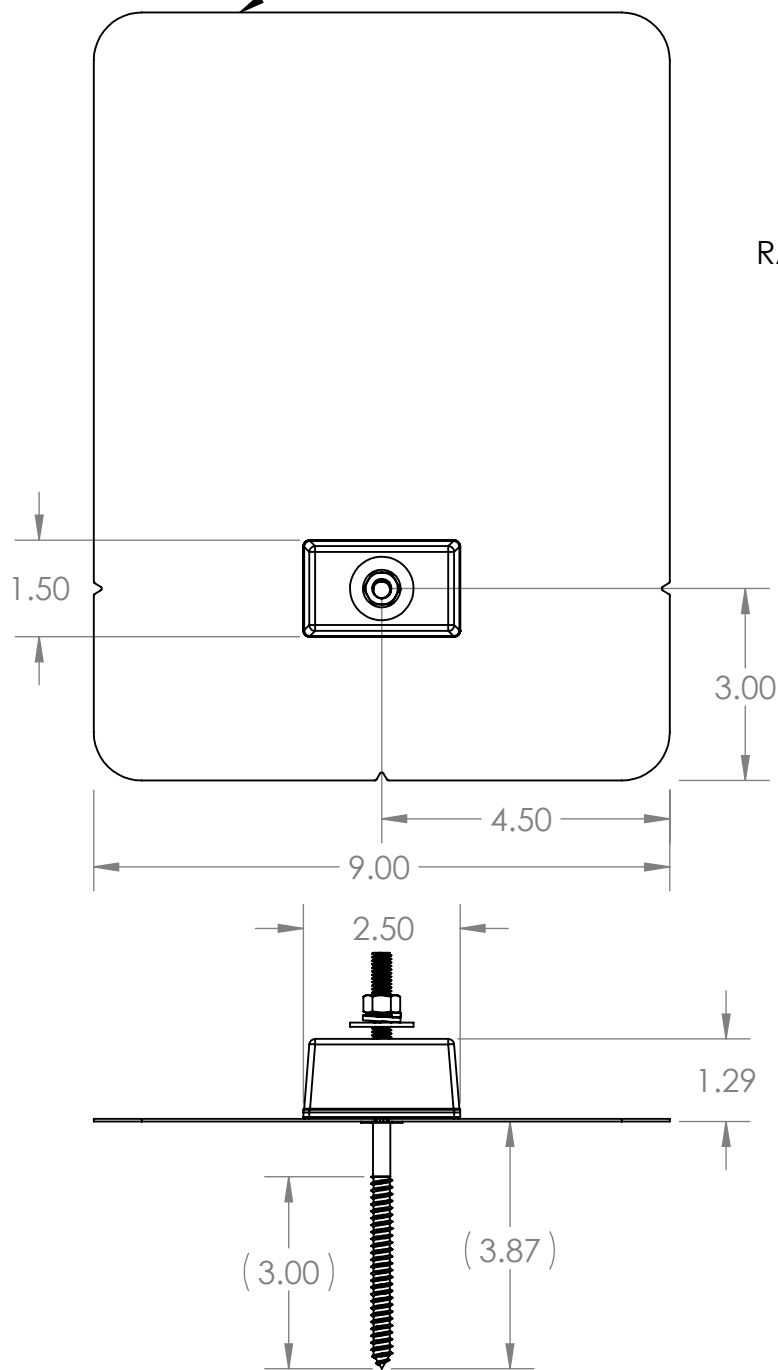

RACKING COMPONENTS NOT INCLUDED

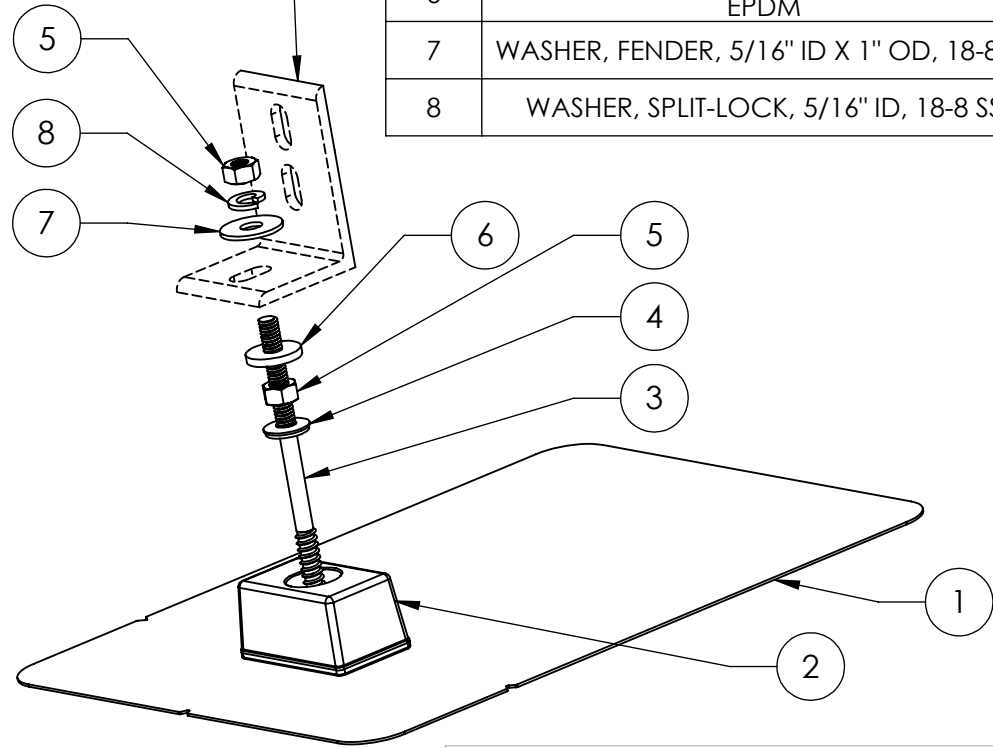

| ITEM NO. | DESCRIPTION | QTY. |
|----------|---|------|
| 1 | FLASHING, ROUNDED CORNERS, 9" X 12" X .040", 5052, MILL | 1 |
| 2 | QBLOCK, CLASSIC, A360 CAST AL, MILL | 1 |
| 3 | HANGER BOLT, 5/16" x 6-1/2", 1-3/4"MT, 3"LT, 18-8 SS | 1 |
| 4 | WASHER, SEALING, 5/16" ID X 3/4" OD, EPDM BONDED SS | 1 |
| 5 | NUT, HEX, 5/16-18, UNC-2B, 18-8 SS | 2 |
| 6 | WASHER, FLAT, 19/64" ID x 7/8" OD x 1/8" EPDM | 1 |
| 7 | WASHER, FENDER, 5/16" ID X 1" OD, 18-8 SS | 1 |
| 8 | WASHER, SPLIT-LOCK, 5/16" ID, 18-8 SS | 1 |

AVAILABLE IN MILL, AND BLACK FINISHES

Quick Mount PV[®]

TITLE:

QMSE-EHB: QMPV E-MOUNT WITH EXTENDED HANGER BOLT

UNLESS OTHERWISE SPECIFIED:

DIMENSIONS ARE IN INCHES
TOLERANCES:
FRACTIONAL ± 1/8
TWO PLACE DECIMAL ±.19
THREE PLACE DECIMAL ±.094

| | | |
|------------------|----------------|-----------------|
| SIZE A | DRAWN BY: RAD | REV 3 |
| | DATE: 5/9/2017 | |
| SCALE: 1:3 | WEIGHT: 0.92 | SHEET 1 OF 1 |